



**三 錦 泵 浦**  
**SUNNY KING PUMPS**

**ANSI-Chem 離心式製程泵浦**  
**ANSI Centrifugal Process Pumps**



ANSI-Chem 離心式製程泵浦  ANSI Centrifugal Process Pumps



性能及外型尺寸  
依ASME/ANSI B73.1標準  
開發設計

Pump performance & outline  
dimensions are designed and  
developed according to  
ASME/ANSI B73.1 standard



廣泛的產品線

Wide production lines



CFD最佳化設計葉輪

CFD optimized impeller

**ACH**

密閉式葉輪系列  
Closed impeller series

**AOH**

半開放 / 開放式葉輪系列  
Semi-open / open impeller  
series

**ACN**

特殊設計動態軸封，專門克  
服惡劣操作條件  
Special dynamic shaft seal  
designed for severe opera-  
tion conditions

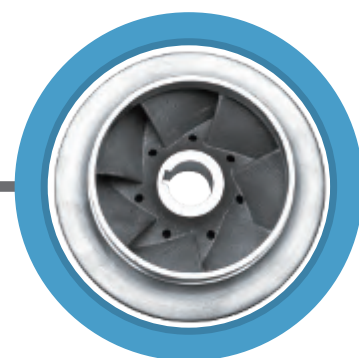
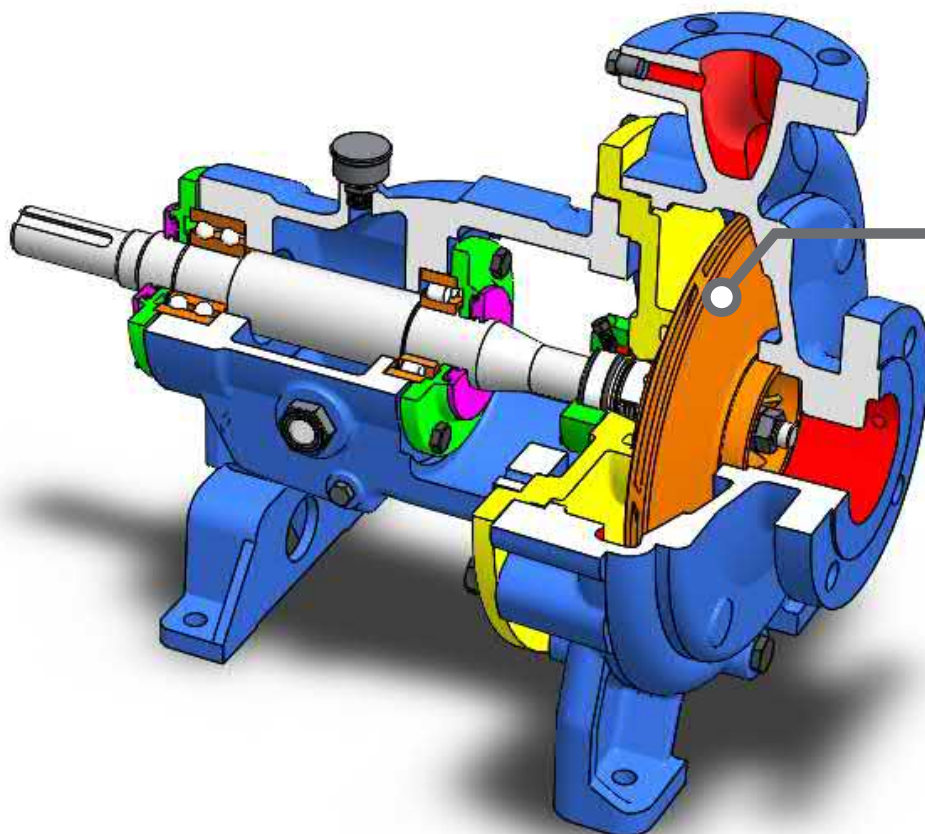

密閉式葉輪  
Closed impeller

ANSI-Chem 離心式製程泵浦  ANSI Centrifugal Process Pumps



重型軸承座

Heavy duty bearing bracket



高性能軸封解決方案

High performance seal solutions



基於客戶應用需要的  
多樣泵附件

Variety of pump accessories based on customer's applications.

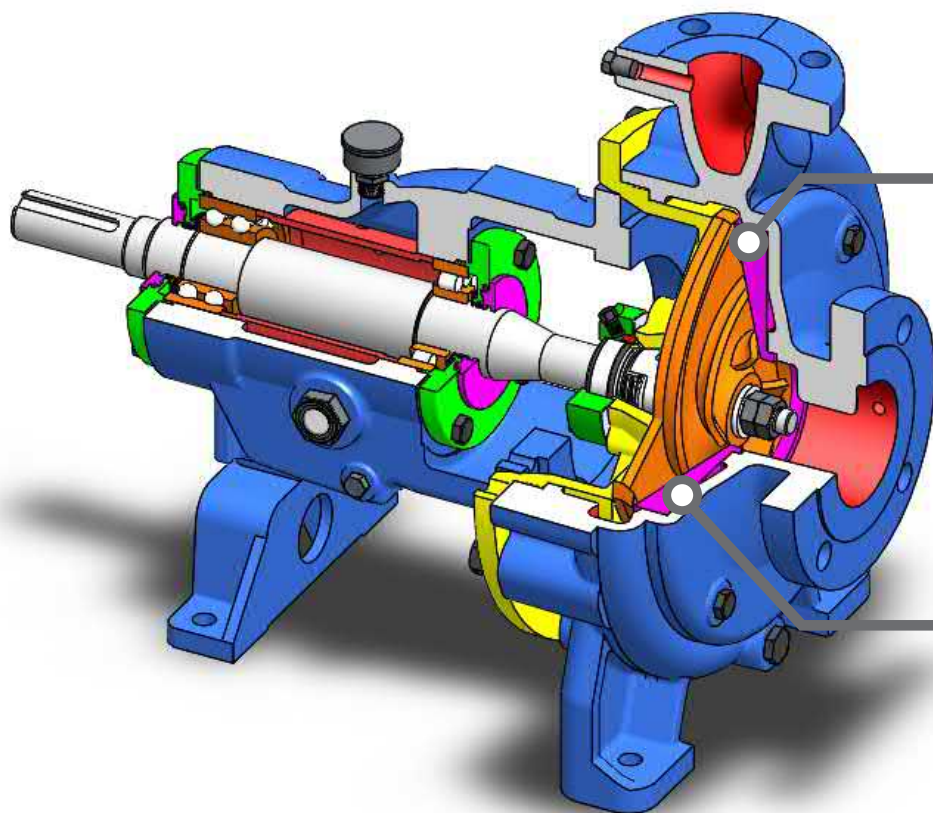

全開放式葉輪  
Open impeller



半開放式葉輪  
Semi-open impeller

ANSI-Chem 離心式製程泵浦  
設計特點Design Features of  
ANSI-Chem Centrifugal Process Pump

## A-TYPE 重型軸承座 A-TYPE Heavy-Duty Bearing Bracket

設計良好，構造堅固的軸承座在泵的運轉可靠度上扮演相當重要的角色。針對化工製程泵的特殊要求，ANSI-Chem製程泵的重型軸承座具有下列特點：

- ◆ 採用高剛性的大尺寸實心軸：實心軸設計可確保密封面處有較低的L3/D4軸撓曲指數，將軸擺幅控制在優於ANSI規範標準的130um以下。其次軸心經過精密加工，表面粗度控制在0.8um以下，可有效減少軸心磨損機率。客戶可另根據需要製作附軸套設計之軸心。
- ◆ 由雙列40度角接觸推力軸承及單列滾柱軸承支撐，可有效增加嚴苛使用下平均L10軸承壽命。
- ◆ 迷宮式軸承密封：ANSI Chem系列將API610所規範使用的迷宮式密封列為標準配備。迷宮式密封利用迷宮環上的曲折路徑隔離水、雜質侵入軸承座，並保持機油不滲漏。由於迷宮式軸承密封為非接觸型設計，其MTBF(Mean Time Between Failure)比傳統唇型油封好上數倍。

A good-design, robust and strong bearing bracket plays a very important role in the operation reliability of pump. For special requirement in chemical process, the heavy-duty bearing bracket of ANSI-Chem process pumps comes with the following features:

- ◆ High-stiffness jumbo size solid shaft: The solid shaft design ensures a low L3/D4 axial deflection index at the seal contact surface, which guarantees the range of shaft deflection under 130um, better than the specification of ANSI standards. In addition, the surface roughness is controlled under 0.8um with precision process to effectively reduce the abrasion of shaft. The shaft with sleeve is also available upon order.
- ◆ The dual-row 40-degree angle-contacting thrust bearing and single-row ball bearings significantly increased L10 bearing life on tough application.
- ◆ Labyrinth bearing seal: ANSI-Chem pumps employ labyrinth seals as standard accessories. The labyrinth seal takes advantage of flexural paths on the labyrinth ring to prevent water and impurities from invading the bearing bracket, and maintain the engine oil without leaking. As the labyrinth seal is a non-contact design, which has MTBF (Mean Time Between Failure) much longer than that of traditional lip seals.

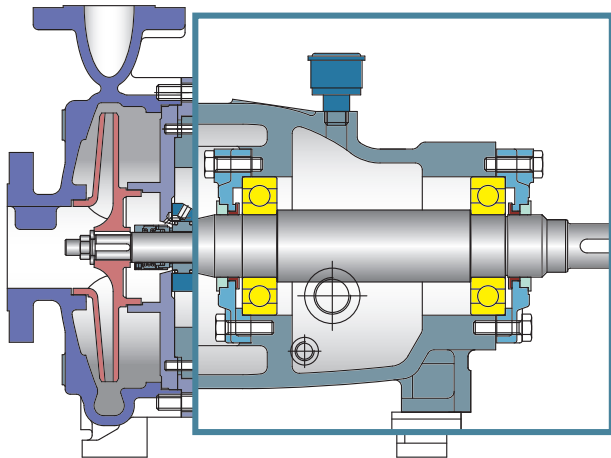

標準型軸承座  
Standard Bearing Bracket

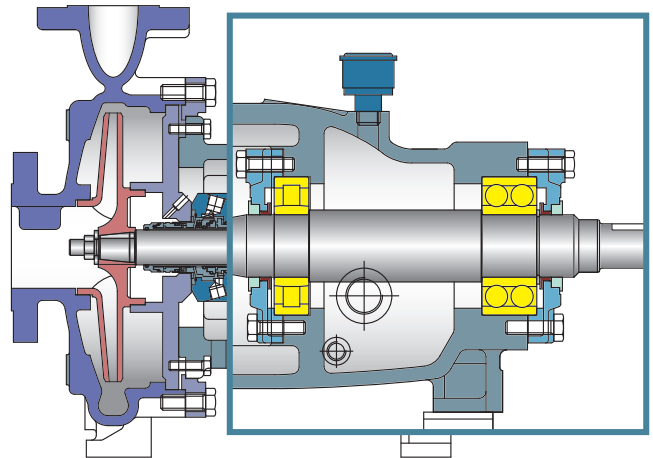

A型軸承座  
A type Bearing Bracket

ANSI-Chem 離心式製程泵浦  
設計特點Design Features of  
ANSI-Chem Centrifugal Process Pump

## 軸承角度誤差防止設計 Bearing Angle Error Prevention Design

維修具有葉輪間隙外部調整結構的AOH, ACN離心式泵浦，最怕遇到軸承安裝品質出現問題。因為高精密度的製程級泵浦，其軸承容許的角度對準誤差都很小。例如製程泵浦上常見的雙列角接觸滾珠軸承，其角度對準誤差僅有兩分弧度(0.03度)，一旦安裝誤差超過容許範圍即會造成軸承壽命顯著下降。

## ◆傳統葉輪間隙外部調整機構

不容易掌握軸承安裝精密度，容易因安裝過程誤差超過容許範圍而使泵浦經常因軸承損壞故障停機。

## ◆改良式葉輪間隙外部調整機構

軸承定位套筒：軸承角度對準誤差被定位套筒的機械精度控制在容許範圍內，可有效防止人工安裝誤差，只需將軸承壓到底即可安裝完成，簡化維修工作及提昇安裝品質

When servicing the centrifugal pump having external impeller clearance adjustment mechanism, the situation that the maintenance person fears the most is the problem with the bearing installation quality because the angle aligning error allowed for the bearing used in high-precision process-class pump is usually very small. Take the double-row angle-contacting ball bearing normally seen in the process pump for example; the angle aligning error is only 2.0 radian (0.03 degrees) so the service life of the bearing would be obviously degraded once the installation error exceeds the allowable range.

◆ Conventional External Impeller Clearance Adjusting Mechanism  
Not easy to control over the precision of bearing installation that the installation error tends to exceed the allowable range easily as to cause the failure downtime of the pump resulting from bearing damage.

◆ Improved External Impeller Clearance Adjusting Mechanism  
With the bearing positioning sleeve design, the bearing angle aligning error can be controlled with the allowable range by the machining precision of the positioning sleeve to effectively prevent the error of manual installation. To install, simply push the bearing to the bottom end. In this way, it can effectively enhance the maintenance accessibility and quality.

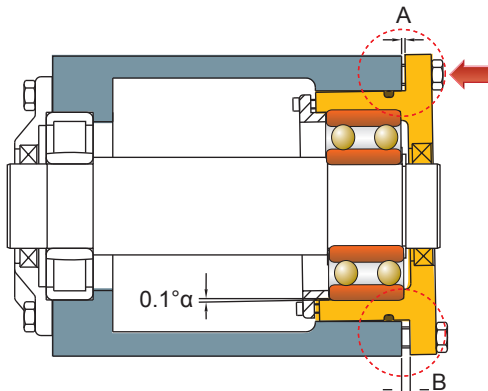
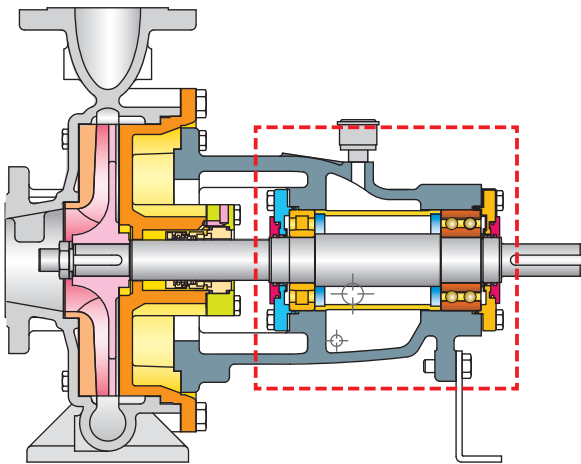

傳統調整結構

## Conventional Adjusting Structure

不容易掌握軸承安裝精密度，容易因安裝過程誤差超過容許範圍而使泵浦經常因軸承損壞故障停機。

Not easy to control over the precision of bearing installation that the installation error tends to exceed the allowable range easily as to cause the failure downtime of the pump resulting from bearing damage.

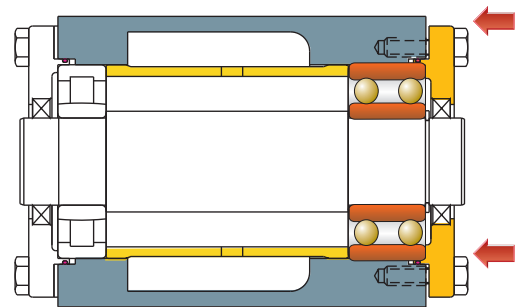

改良式調整結構

## Improved Adjusting Structure

軸承定位套筒設計，軸承角度對準誤差被機械加工精度控制在容許範圍內，可有效防止人工安裝誤差，只需將軸承壓到底即可安裝完成，有效提升維修便利性及品質。

With the bearing positioning sleeve design, the bearing angle aligning error can be controlled within the allowable range by the machining precision to effectively prevent the error of manual installation. To install, simply push the bearing to the bottom end. In this way, it can effectively enhance the maintenance accessibility and quality.

ANSI-Chem 離心式製程泵浦  
設計特點Design Features of  
ANSI-Chem Centrifugal Process Pump

## 高剛性底座系統 High-stiffness Baseplate System

穩固的底座使泵浦及馬達保持準確定位，而且能吸收泵運轉震動。ANSI-Chem 泵底座依客戶需求主要提供碳鋼及不鏽鋼等材質。

底座系統選用附件：

- ◆ 專利馬達可調整型底座：提供馬達微調功能，可提升馬達安裝便利性。
- ◆ 化學集液盤：如泵浦使用於輸送高危險性流體，萬一具毒性或高為害輸送介質液因泵故障而產生洩漏時，可由集液盤收集引流，以避免發生環境汙染。集液盤材質一般為耐蝕不鏽鋼。

The firm baseplate enables precision positioning of pumps and motors as well as absorbs the vibration during pump operation. ANSI-Chem pump baseplate provide major material options - carbon steel and stainless steel, available based on customer's demand.

Optional accessories for baseplate system:

- ◆ Patented adjustable baseplate for motor: for motor position fine tuning; facilitate motor installation convenience.
- ◆ Chemical drain pan: In case of conveying hazardous fluids by pumps, to prevent leakage of toxic fluids due to pump failure, the drain pan collects and drain the fluid to avoid environment contamination. The regular material of drain pan is anti-corrosion stainless steel.

## 聯軸器護罩 Coupling Guard

標準配備的U型聯軸器護罩可提供基本的機械安全防護。三錦公司可根據客戶需要提供全罩式聯軸器護罩及軸封護罩，以符合ISO 14120, EN 953或ANSI B15.1機械安全標準。

The U-shape coupling guard, as a standard accessory, offers basic mechanical safety protection. SUNNY KING provides full-coverage coupling guard and shaft seal guard on demand in order to meet mechanical safety standards ISO 14120, EN 953 or ANSI B15.1.

## 聯軸器 Coupling

三錦標準配備為E-Flex型爪式彈性聯軸器，安裝保養容易，成本/效能比值高，為最超值選擇。

可選用之其他形式聯軸器：

- ◆ 膠套式聯軸器：  
利用齒型彈性體連接兩軸來傳遞轉矩並補償軸偏差。膠套式聯軸器最大優點為優異的扭轉撓性。此外，當運轉異常時只會導致聯軸器彈性體剪斷，對軸心部位形成保護作用。膠套式聯軸器為API 建議使用之聯軸器。
- ◆ 鋼片式聯軸器：  
FD型剛性聯軸器採用不鏽鋼材質金屬鋼片，無須潤滑，使用壽命特長。FD4剛性聯軸器能提供比同尺寸彈性聯軸器更高的傳遞轉矩能力。其專利附中間套易拆結構設計不需調整背隙及對軸心，可簡化拆裝程序。鋼片式聯軸器為API建議使用之聯軸器。

SUNNY KING's standard E-Flex claw-type elastic couplings are easy for installation and maintenance, which has high a cost-performance ratio, making it the most cost-effective choice.

Other optional coupling types:

- ◆ Elastomer sleeve coupling:  
Use a gear-shape elastomer to connect two shafts for conveying torque and compensating axial error. The most significant advantage of rubber sleeve coupler is its superior torsional flexibility. In addition, as abnormal operation causes only the breakage of coupling's elastomer, the shaft part is thereby protected. API suggests rubber sleeve couplers for usage.
- ◆ Disc coupling:  
The FD type disc coupling uses stainless steel discs that requires no lubrication while having an extreme long life. It provides higher torque transmission than an elastic coupling of similar sizes. The patented design of easy-removal intermediate sleeve design requires no backlash adjustment and shaft alignment, which simplifies the dismantling procedure. API suggests steel disc coupling for usage.



馬達可調整型底座  
Motor-adjustable Baseplate



全罩式聯軸器護罩及軸封護罩  
Full Shield Coupling & Seal Guard



E-FLEX聯軸器  
E-FLEX Shaft Coupling

## 泵浦選用附件 Pump Optional Accessories

### 密封系統 Sealing System

軸封的選用與配置影響泵浦壽命甚大，必須考慮泵浦工作液體特性如酸鹼度、壓力、溫度以及雜質含量程度等多項因素，如必要時甚至需針對軸封結構作修改設計。只有具備足夠專業能力廠商才能確保軸封元件得到最佳壽命。ANSI Chem離心式製程泵浦可選用單軸封、雙軸封、卡式軸封等等多種類型軸封，例如以ISO 3069/DIN 24960 標準設計之機械軸封，亦可選用API 682 標準所建議Big Bore 設計的機械軸封。

The selection and installation of shaft seal has huge influence on pump's life, which requires considering the fluid characteristics for which the pump operates, such as PH value, pressure, temperature, impurity level etc. Sometimes the bearing seal design shall be modified if necessary. Only qualified professional vendors can ensure the best life of bearing seals. There are many types of shaft seal to be selected and used in ANSI Chem centrifugal process pumps, such as single-acting mechanical seal, double-acting mechanical seal and cartridge mechanical seal, etc. For example, the selection of mechanical seals designed in accordance to ISO 3069/DIN 24960 standard or those of Big Bore design suggested by API standard 682 are both appropriate.

泛用型機械軸封  
Universal Mechanical Seal



化工型機械軸封  
Chemical Mechanical Seal

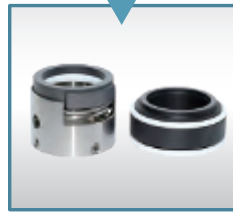

卡式型機械軸封  
Cartridge Mechanical Seal



### 延長軸封壽命的軸封函設計 Design of seal chamber for seal life extension

- ◆ 錐孔軸封函  
於化工製程使用化工型軸封或卡式軸封時，軸封函為錐形開孔結構，可更容易排除累積在軸封元件的污染物，延長軸封使用壽命。
- ◆ 闊孔軸封函  
藉由增大軸封與軸封函壁之間的徑向間隙，使機械軸封對磨面得到較好的循環及散熱效果，以延長軸封使用壽命。如果搭配結構設計優良的軸封，效果更佳。
- ◆ Conical Seal Chamber  
When using single acting mechanical seal or cartridge mechanical seal, the seal chamber with conical opening can easily self-vent the contaminations accumulated in seal component in order to prolong the service life of seal.
- ◆ Big Bore Chamber  
By increasing the axial clearance between the bearing seal and the seal chamber wall, the mechanical seal chamber has a better circulation and heat dissipation against the friction plane, and thereby the service life of seal is extended. A better effect can be obtained by using a good structurally designed bearing seal.

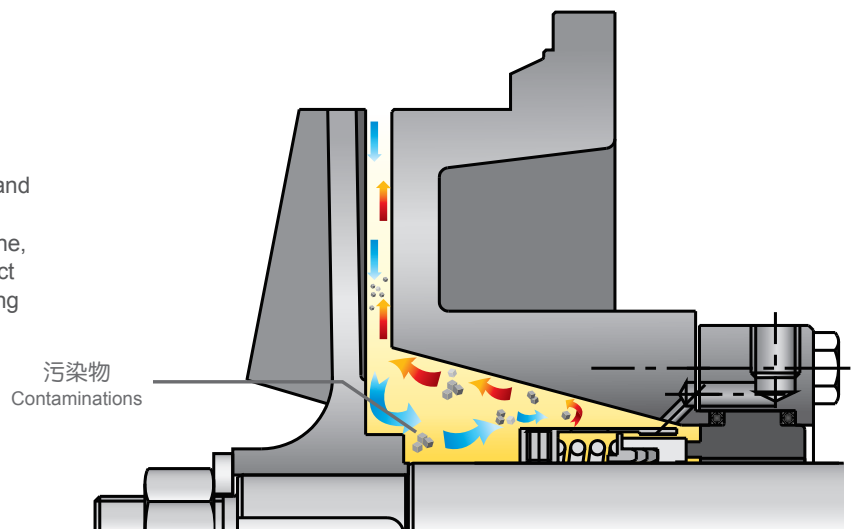

針對高性能需求的機械軸封  
解決方案



Solutions of  
High Performance Mechanical Seal

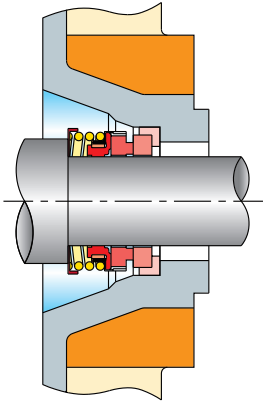

泛用型單機械軸封  
Universal Single-acting  
Mechanical Seal

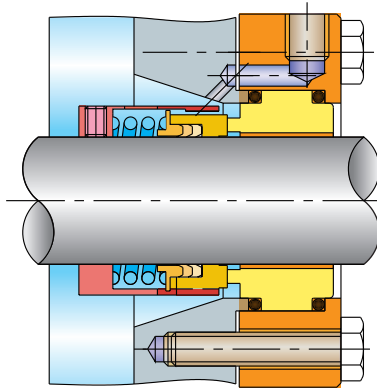

化工型單機械軸封  
Chemical Single-acting  
Mechanical Seal

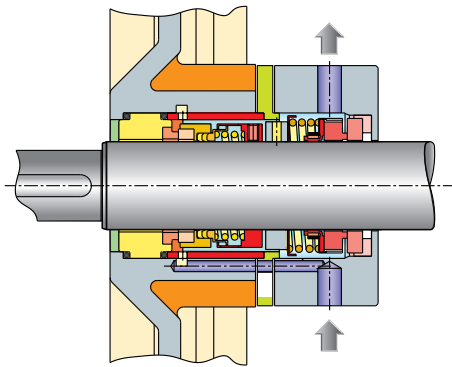

雙機械軸封—背對背配置  
Double-acting Chemical Mechanical Seal,  
Back-to-back Arrangement

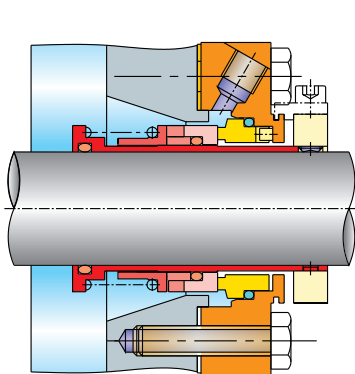

卡式單機械軸封  
Cartridge Single-acting  
Mechanical Seal

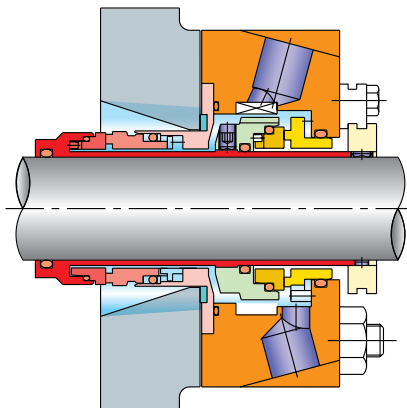

卡式雙機械軸封  
Cartridge Double-acting  
Mechanical Seal

單機械軸封

- ◆ 一般用途的單彈簧設計或是化工製程用的多彈簧設計
- ◆ O-ring可選用NBR, Viton, PTFE or Kalrez elastomer

Single-acting Mechanical Seal

- ◆ Single spring design for general use or multi-spring design for chemical process use
- ◆ O-ring materials:  
NBR, Viton, PTFE or Kalrez elastomer

雙機械軸封—背對背配置

- ◆ H9E+EA560
- ◆ 外沖或內循環接頭
- ◆ 可選配軸襯套
- ◆ O-ring可選用NBR, Viton, PTFE或Kalrez合成橡膠
- ◆ Barrier liquid connection
- ◆ Shaft sleeve

Double-acting chemical mechanical seal,  
back-to-back arrangement

- ◆ H9E+EA560
- ◆ Quench or circulation connector
- ◆ Optional shaft sleeve
- ◆ O-ring materials:  
NBR, Viton, PTFE or Kalrez elastomer
- ◆ Barrier liquid connection

卡式機械軸封

- ◆ 單或雙軸封
- ◆ 具備外沖或內循環接孔
- ◆ 附軸襯套
- ◆ O-ring可選用NBR, Viton, PTFE或Kalrez合成橡膠

Cartridge mechanical seal

- ◆ Single or Double-acting mechanical seal
- ◆ Quench or circulation connector  
with shaft sleeve
- ◆ O-ring materials:  
NBR, Viton, PTFE or Kalrez elastomer



## 針對高性能需求的機械軸封 解決方案



Solutions of  
High Performance Mechanical Seal

### 軸封沖洗 Seal Flushing

針對製程需要，三錦ANSI-Chem離心泵浦可依據ANSI B73.1 或 API 682/ ISO 21049 軸封沖洗規範施工。

Depending on the need of the process, SUNNY KING's centrifugal process pump can be mounted pursuant to ANSI B73.1 or API 682/ ISO 21049 standard on seal flushing plans

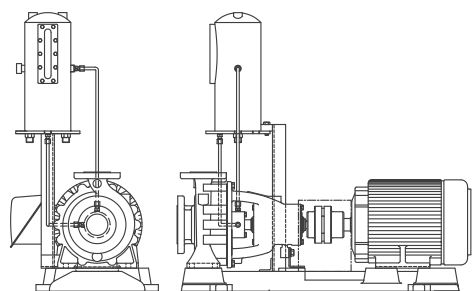

PLAN53

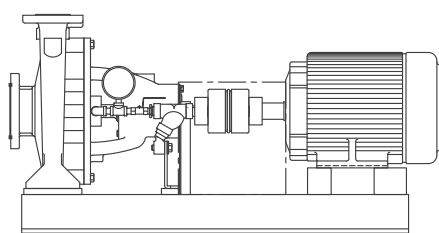

PLAN32



PLAN53 (Customized)

### 泵浦加熱及冷卻系統 Pump Heating and Cooling System

為確保抽取的液體能得到適當加熱或冷卻，三錦離心式製程泵浦可依據ANSI B 73.1 泵浦加熱及冷卻系統配管規範(例如機殼及軸封夾套)進行施工，並可依據客戶需求配置。

To ensure proper heating or cooling for pumped fluid, SUNNY KING centrifugal process pump can be constructed with heating and cooling system pipeline according to ANSI B73.1 standard (i.e. casing or seal chamber jacket). Further, the pump can also be arranged according to the customer requirements.



泵浦附軸封沖洗及機殼夾套  
Pump with Flush Plan & Casing Jacket

## ACH 臥式單段密閉葉輪型



## ACH Horizontal Single-stage pump with Enclosed Impeller

## 特點 Features

- ◆ 適用於一般條件下的液體輸送
- ◆ 採用經水力平衡設計密閉式葉輪，實現更小的軸向力
- ◆ 可選用葉輪磨蝕環

- ◆ Applied to liquid transmission under general conditions
- ◆ The hydraulic balance design of enclosed impeller realizes a smaller axial force.
- ◆ Optional impeller wearing ring

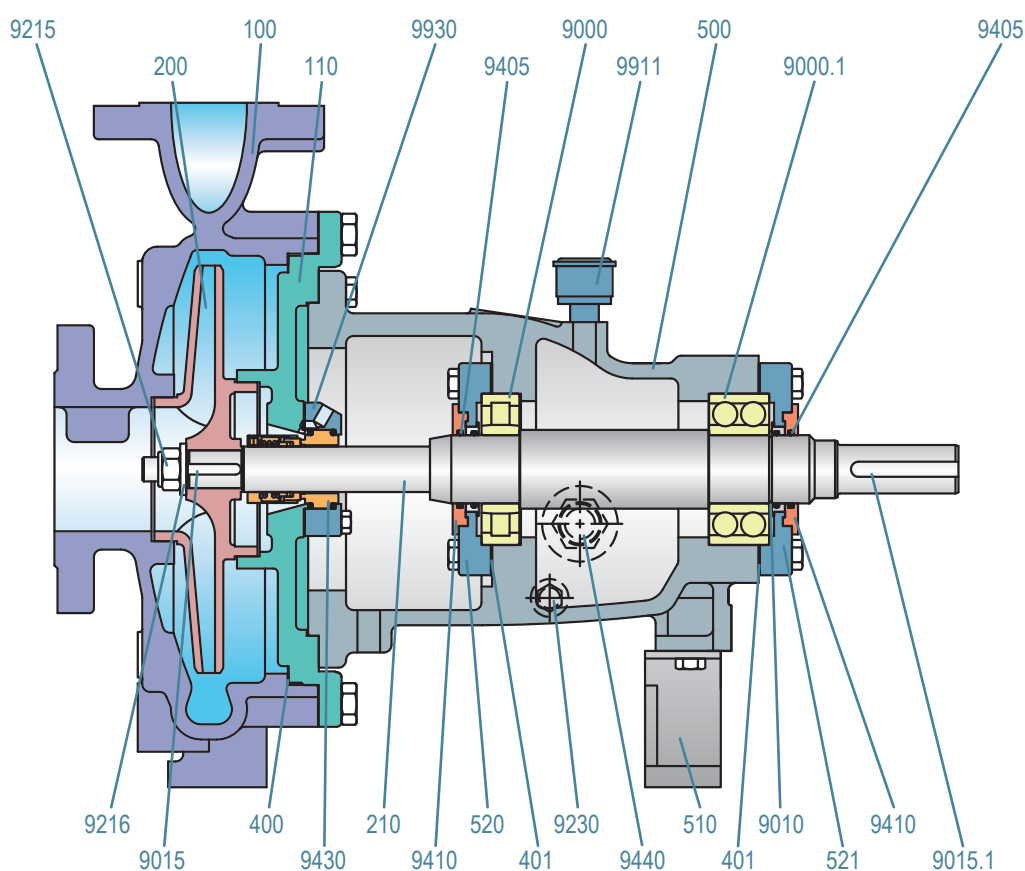

編號 NO.	名稱 Parts Name	Mat.1	Mat.2	Mat.3	編號 NO.	名稱 Parts Name	Mat.1	Mat.2	Mat.3
100	機殼 Casing	FC200	SCS13	SCS14	9010	c扣環 Circlip	SK7	SK7	SK7
110	中間支座 Adaptor(with Integral Seal Chamber)	FC200	SCS13	SCS14	9015	葉輪固定鍵 Key, Impeller	SUS304	SUS304	SUS316
200	葉輪 Impeller	BC	SCS13	SCS14	9015.1	聯軸器固定鍵 Key, Coupling	S45C	S45C	S45C
210	軸 Shaft	SUS410	SUS304	SUS316	9215	葉輪防鬆螺帽 Locknut, Impeller	SUS304	SUS304	SUS316
400	中間支座墊片 Gasket, Adaptor	非石棉 Non-asbestos			9216	葉輪螺帽防鬆墊圈 Lockwasher, Impeller	SUS304	SUS304	SUS316
401	軸承蓋墊片 Gasket, Bearing Cover	非石棉 Non-asbestos			9230	洩油孔塞頭 Oil Drain Boss	FC200	FC200	FC200
500	軸承座 Bearing Bracket	FC200	FC200	FC200	9405	O型環 O-Ring	NBR	NBR	NBR
510	支架 Support Foot	FC200	FC200	FC200	9410	迷宮式擋水環 Labyrinth Water Slinger	AL	AL	AL
520	軸承蓋 Bearing Cover	S45C	S45C	S45C	9440	油鏡 Oil Sight Glass	AL	AL	AL
521	軸承蓋 Bearing Cover	S45C	S45C	S45C	9930	軸封蓋 Seal Chamber / Stuffing Box Cover	FC200	SUS304	SUS316
9000	非傳動側軸承 Bearing, Driven Side	Single row deep groove Single row cylindrical			9911	油杯 Oil Cup	BC	BC	BC
9000.1	傳動側軸承 Bearing, Driving Side	Single row deep groove Double row angular contact			9430	機械軸封 Mechanical Seal	According to mechanical seal type		

# AOH 臥式單段 半開放/開放葉輪型



# AOH Horizontal Single-stage pump with Semi-open/Open Impeller

## 特點 Features

- ◆ 適用於液體雜質含量多的特殊條件下使用
- ◆ 採用加背葉的半開放或開放式葉輪，減少軸向推力，並提升處理含顆粒或長纖維液體效能。
- ◆ 可更換機殼摩擦板：機殼摩擦板磨損後可更換，不必更換整個機殼。
- ◆ 改良式葉輪間隙外部調整機構，簡化維修難度，令軸承壽命更加穩定。

- ◆ Applied to the special condition of high impurity in liquids
- ◆ Standard semi-open or optional open type impeller with back vanes to reduce axial thrust and to enhance the efficiency of processing grain or long-fiber contained liquid.
- ◆ Replaceable casing wear plate: replace only the worn-out casing wear plate instead of the whole casing.
- ◆ Improved impeller clearance adjusting mechanism: The improved adjusting mechanism simplifies the maintenance difficulty for impeller clearance adjustment, realizing a more stable service life of bearing.

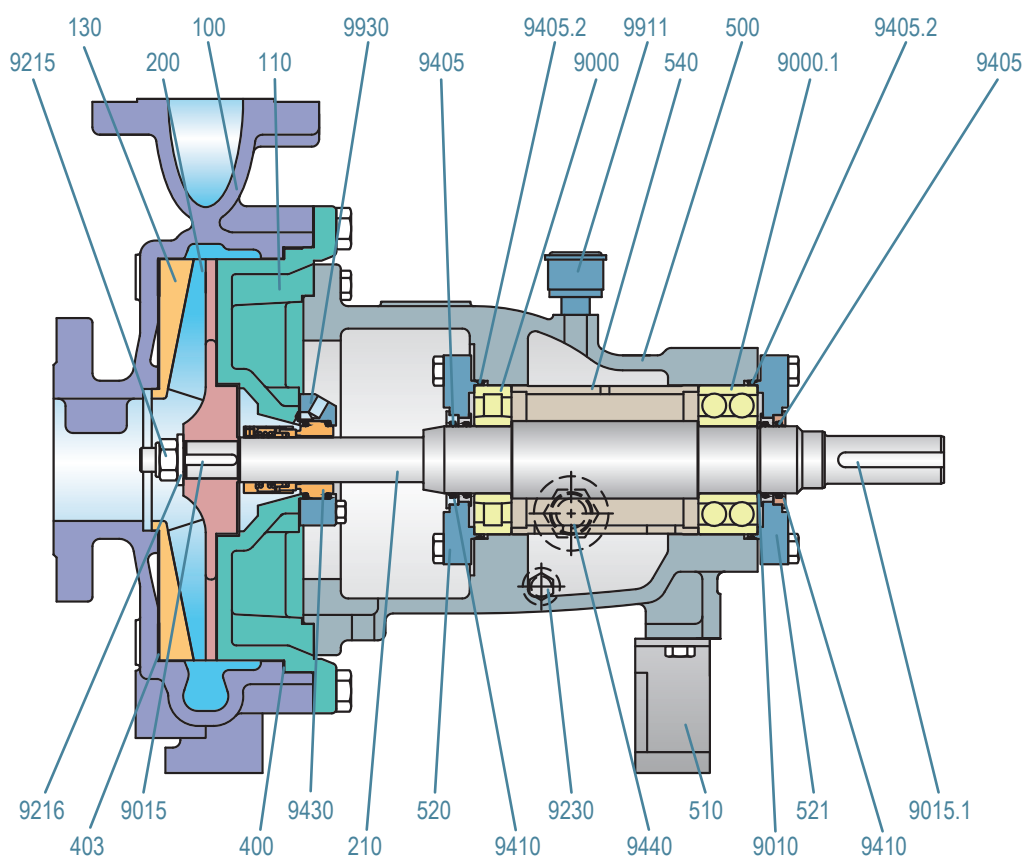

編號 NO.	名稱 Parts Name	Mat.1	Mat.2	Mat.3	編號 NO.	名稱 Parts Name	Mat.1	Mat.2	Mat.3
100	機殼 Casing	FC200	SCS13	SCS14	9010	c扣環 Circlip	SK7	SK7	SK7
110	中間支座 Adaptor(with Integral Seal Chamber)	FC200	SCS13	SCS14	9015	葉輪固定鍵 Key, Impeller	SUS304	SUS304	SUS316
130	機殼摩擦板 Wear Plate	FC200	SCS13	SCS14	9015.1	聯軸器固定鍵 Key, Coupling	S45C	S45C	S45C
200	葉輪 Impeller	BC	SCS13	SCS14	9215	葉輪防鬆螺帽 Locknut, Impeller	SUS304	SUS304	SUS316
210	軸 Shaft	SUS410	SUS304	SUS316	9216	葉輪螺帽防鬆墊圈 Lockwasher, Impeller	SUS304	SUS304	SUS316
400	中間支座墊片 Gasket, Adaptor	非石棉 Non-asbestos			9230	洩油孔塞頭 Oil Drain Boss	FC200	FC200	FC200
403	摩擦板墊片 Gasket, Wear Plate	非石棉 Non-asbestos			9405	O型環 O-Ring	NBR	NBR	NBR
500	軸承座 Bearing Bracket	FC200	FC200	FC200	9405.2	O型環 O-Ring	NBR	NBR	NBR
510	支架 Support Foot	FC200	FC200	FC200	9410	迷宮式擋水環 Labyrinth Water Slinger	AL	AL	AL
520	軸承蓋 Bearing Cover	S45C	S45C	S45C	9440	油鏡 Oil Sight Glass	AL	AL	AL
521	軸承蓋 Bearing Cover	S45C	S45C	S45C	9930	軸封蓋 Seal Chamber / Stuffing Box Cover	FC200	SUS304	SUS316
540	軸承定位套筒 Bearing Position Sleeve	SS400	SS400	SS400	9911	油杯 Oil Cup	BC	BC	BC
9000	非傳動側軸承 Bearing, Driven Side	Single row deep groove Single row cylindrical			9430	機械軸封 Mechanical Seal	According to mechanical seal type		
9000.1	傳動側軸承 Bearing, Driving Side	Single row deep groove Double row angular contact							

## ACN 臥式單段動態密封系統 + 半開放/開放葉輪型



## ACN Horizontal Single-stage Dynamic Seal Pump with Semi-open/Open Impeller

### 特點 Features

- ◆ 適用於液體雜質含量多且有磨耗顆粒的嚴格條件下使用。
- ◆ 動態密封系統:由前段輔助葉輪加上後段軸封部組成的動態密封系統來阻止液體洩漏。由於後段軸封部密封面不直接接觸輸送液體，在機械軸封壽命不佳的操作條件下有優良的使用壽命。後段軸封部標準為填料軸封，可升級為Plan 53軸封沖洗方案以使用於嚴禁液體洩漏場所。
- ◆ 可更換機殼摩擦板：機殼摩擦板磨損後可更換，不必更換整個機殼。
- ◆ 改良式葉輪間隙外部調整機構：改良式葉輪間隙外部調整機構，簡化維修難度，令軸承壽命更加穩定。

- ◆ Applied to harsh conditions of high impurity and solid particles in liquids
- ◆ Dynamic sealing system: Prevent liquid leakage by a dynamic sealing system, which is composed of two parts: a front-stage auxiliary impeller and a rear-stage shaft seal. As the sealing surface of rear-stage shaft seal does not directly contact with the liquid, a good service life still can be achieved under an operation condition even if the mechanical seal life is poor. The rear-stage shaft seal can be upgraded to the Plan 53 seal flushing solution from the standard soft packing seal, which is suitable to be used in the environment where liquid leakage is strictly prohibited.
- ◆ Replaceable casing wear plate: replace only the worn-out casing wear plate instead of the whole casing.
- ◆ Improved impeller clearance adjusting mechanism: The improved adjusting mechanism simplifies the maintenance difficulty for impeller clearance adjustment, realizing a more stable service life of bearing.

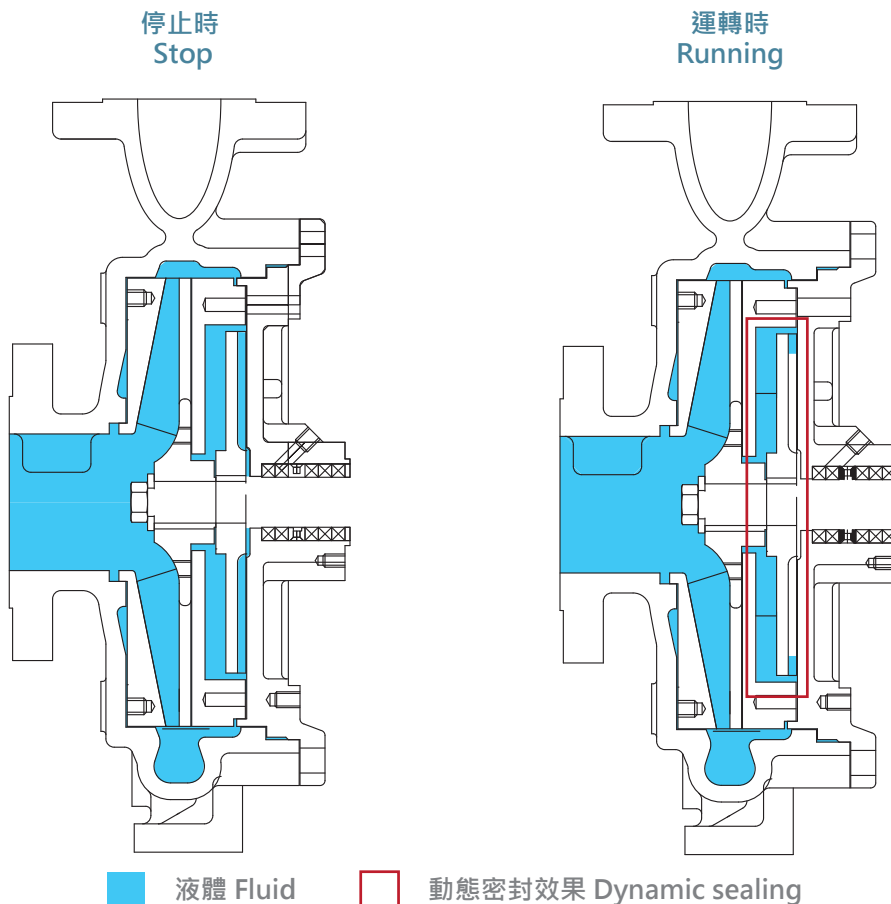

ACH AOH ACN 離心式製泵浦系列性能選擇表  
Performance Curve of ACH AOH ACN Series

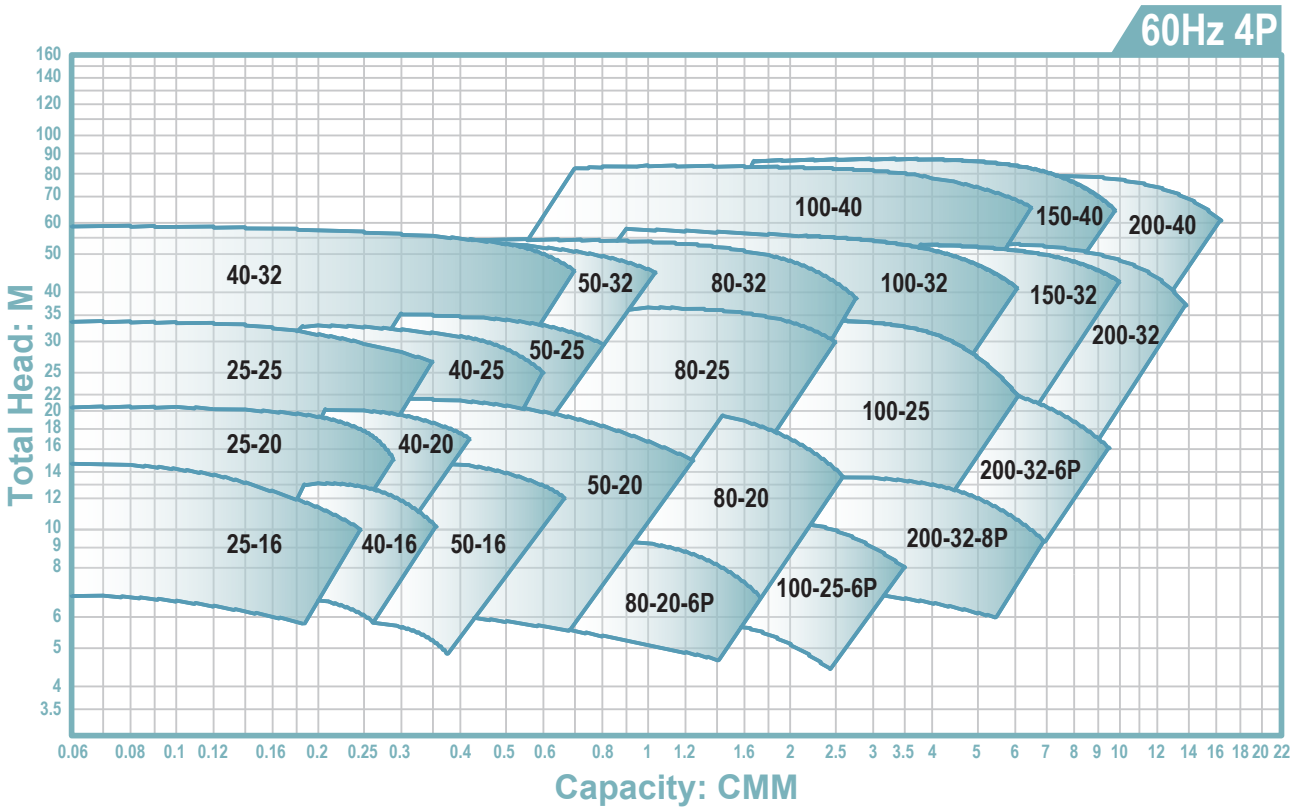
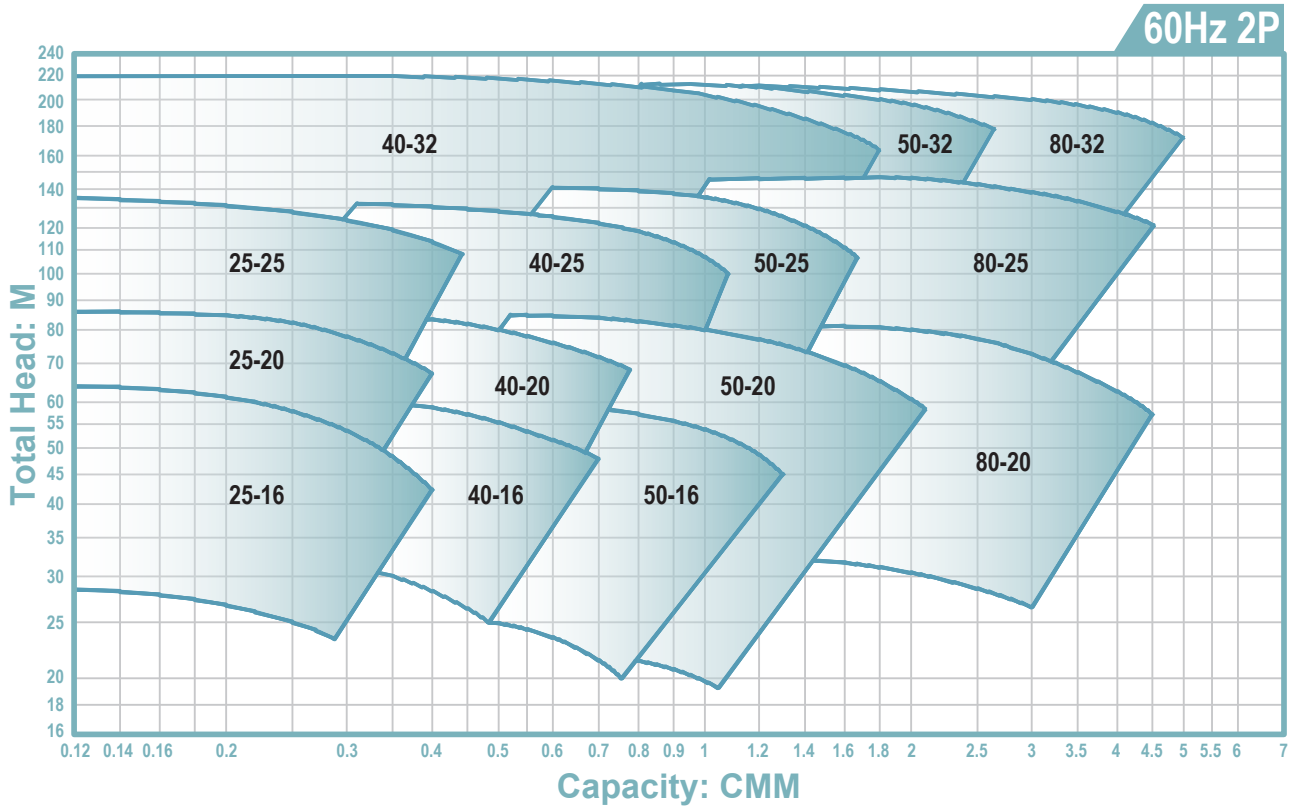

ACH AOH ACN 離心式製泵浦系列外型尺寸圖

Dimension of ACH AOH ACN Series

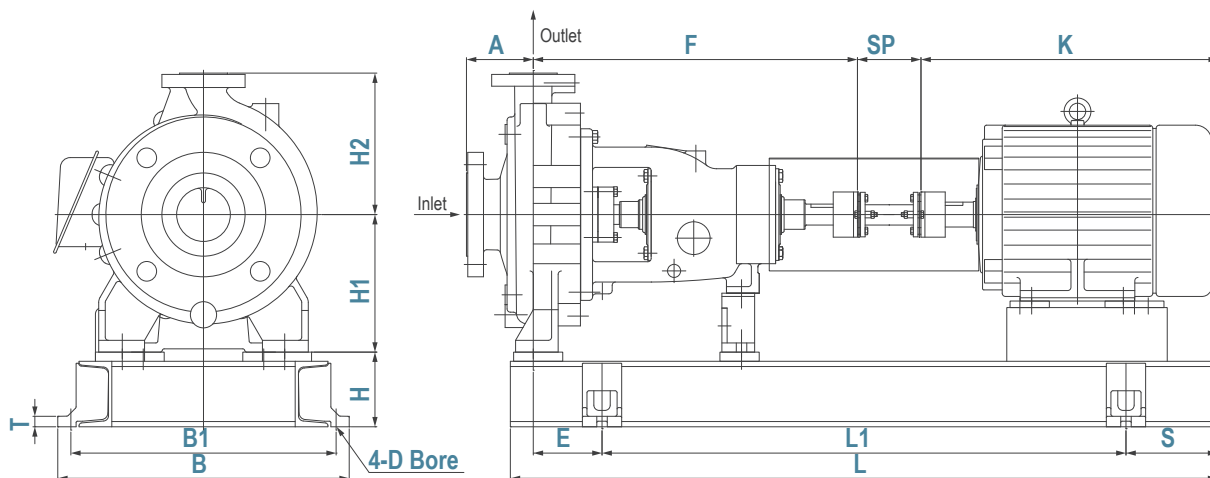

ST

泵浦型號 Pump Size	入口 Inlet	出口 Outlet	A	F	H1	H2	馬達框號 IEC Frame	L	L1	B	B1	H	SP	D	E	T	S	K
25-16	1.5"	1"	102	343	133	165	80	690	500	325	295	89	97	15	68	16	95	282.5
40-16	3"	1.5"				165	90L	730	500	325	295	89	97	15	88	16	115	332.5
							100L	770	500	325	295	89	97	15	108	16	135	374.5
							112M	770	500	355	325	89	97	15	108	16	135	391.5
							132S/M	840	700	385	355	89	97	15	43	16	70	492
							160M/L	970	800	445	405	141	97	15	58	16	85	652
50-16	3"	2"	102	343	178	165	80	690	500	325	295	89	97	15	68	16	95	282.5
25-20	1.5"	1"				165	90L	730	500	325	295	89	97	15	88	16	115	332.5
40-20	3"	1.5"				190	100L	770	500	325	295	89	97	15	108	16	135	374.5
							112M	770	500	355	325	89	97	15	108	16	135	391.5
							132S/M	840	700	385	355	89	97	15	43	16	70	492
							160M/L	970	800	430	390	114	97	15	58	16	85	652

MT

泵浦型號 Pump Size	入口 Inlet	出口 Outlet	A	F	H1	H2	馬達框號 IEC Frame	L	L1	B	B1	H	SP	D	E	T	S	K
50-20	3"	2"	102	495	210	242	80	840	700	420	390	89	97	15	43	16	70	282.5
80-20	4"	3"				280	90L	880	700	420	390	89	97	15	63	16	90	332.5
25-25	2"	1"				216	100L	920	700	420	390	89	97	15	83	16	110	374.5
40-25	3"	1.5"				216	112M	920	700	420	390	89	97	15	83	16	110	391.5
50-25	3"	2"				242	132S/M	1000	800	420	390	89	97	15	73	16	100	492
80-25	4"	3"				280	160M/L	1140	800	445	405	114	97	15	135	16	170	652
							180M	1180	800	490	450	114	97	15	155	16	190	710
							180L	1270	800	510	460	139	139	19	200	20	235	764
							200LA	1260	800	560	510	139	97	19	195	20	230	809.5
							225SA	1320	900	640	580	179	139	23	175	24	210	850
							250SA	1300	900	700	640	210	139	23	165	24	200	852.5
							250MA	1450	1000	700	640	210	190	23	190	24	225	947.5
							280SA	1440	1000	750	690	290	190	23	185	24	220	966
100-25	6"	4"	102	495	254	343	112M	920	700	420	390	89	97	15	83	16	110	391.5
40-32	3"	1.5"				266	132S/M	1000	800	420	390	89	97	15	73	16	100	492
50-32	3"	2"				292	160M/L	1140	800	445	405	114	97	15	135	16	170	652
80-32	4"	3"				318	180M	1180	800	490	450	114	97	15	155	16	190	710
							180L	1270	800	510	460	139	139	19	200	20	235	764
							200LC	1380	900	560	510	139	190	19	205	20	240	839.5
							225SC	1400	1000	640	580	164	190	23	165	24	200	880
							250SC	1380	900	700	640	166	190	23	205	24	240	882.5
							250MC	1480	1000	700	640	166	190	23	205	24	240	977.5
							280SC	1500	1000	750	690	246	190	23	215	24	250	1026

MTL

泵浦型號 Pump Size	入口 Inlet	出口 Outlet	A	F	H1	H2	馬達框號 IEC Frame	L	L1	B	B1	H	SP	D	E	T	S	K
100-32	6"	4"	102	495	254	343	160M/L	1140	800	445	405	114	97	15	135	16	170	652
							180M	1180	800	490	450	114	97	15	155	16	190	710
							180L	1270	800	510	460	139	139	19	200	20	235	764
							200LC	1380	900	560	510	139	190	19	205	20	240	839.5
							225SC	1400	1000	640	580	164	190	23	165	24	200	880
							250SC	1380	900	700	640	166	190	23	205	24	240	882.5
							250MC	1480	1000	700	640	166	190	23	205	24	240	977.5
							280SC	1500	1000	750	690	246	190	23	215	24	250	1026

LT

泵浦型號 Pump Size	入口 Inlet	出口 Outlet	A	F	H1	H2	馬達框號 IEC Frame	L	L1	B	B1	H	SP	D	E	T	S	K
100-40	6"	8"	152	708	368	406	180M	1400	1000	660	610	145	97	19	160	20	200	710
150-32	8"	6"				457	180L	1500	1000	660	610	145	97	19	210	20	250	764
200-32	10"	8"				483												
150-40	8"	6"				457												

## ACH AOH ACN 離心式製泵浦系列外型尺寸圖

Dimension of ACH AOH ACN Series

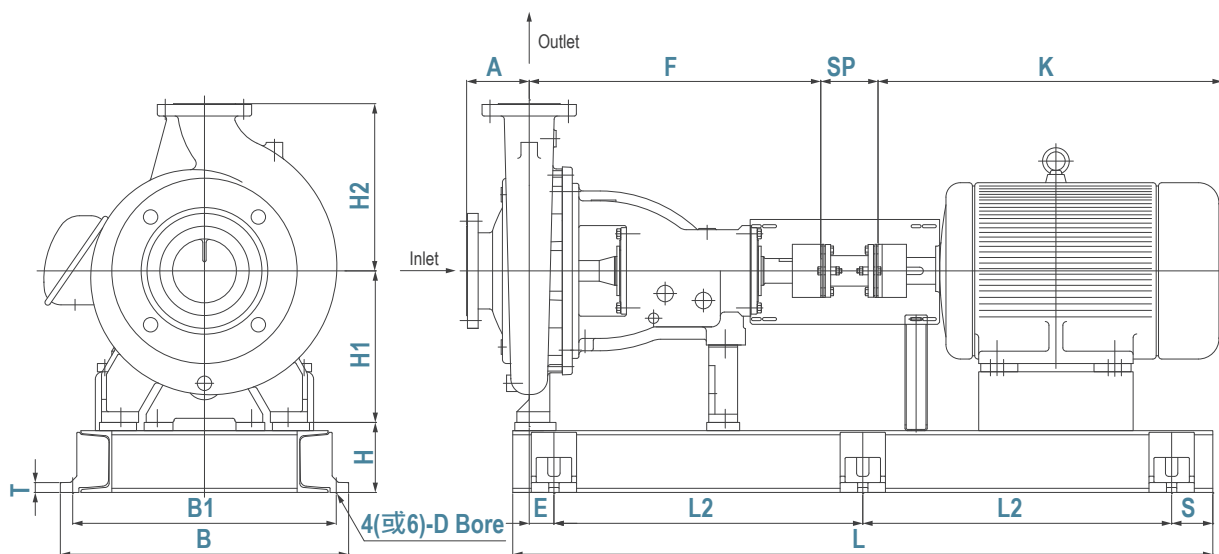

## LT

泵浦型號 Pump Size	入口 口徑 Inlet	出口 口徑 Outlet	A	F	H1	H2	馬達框號 IEC Frame	L	L2	B	B1	H	SP	D	E	T	S	K
100-40	6"	8"	152	708	368	406	200LC	1600	700	660	610	145	190	19	60	20	100	839.5
150-32	8"	6"				457	225SC	1620	700	700	640	170	190	23	70	24	110	880
200-32	10"	8"				483	250SC	1620	700	700	640	170	190	23	70	24	110	882.5
150-40	8"	6"				457	250MC	1700	750	700	640	170	190	23	60	24	100	977.5
						280SC	1720	750	760	700	220	190	23	70	24	110	1026	
						280MC	1770	750	760	700	220	190	23	95	24	135	1077	

## XLT

泵浦型號 Pump Size	入口 口徑 Inlet	出口 口徑 Outlet	A	F	H1	H2	馬達框號 IEC Frame	L	L2	B	B1	H	SP	D	E	T	S	K
200-40	10"	8"	152	708	368	483	225SC	1620	700	700	640	170	190	23	70	24	110	880
							250SC	1620	700	700	640	170	190	23	70	24	110	882.5
							250MC	1700	750	700	640	170	190	23	60	24	100	977.5
							280SC	1720	750	760	700	220	190	23	70	24	110	1026
							280MC	1770	750	760	700	220	190	23	95	24	135	1077
							315S	1790	750	820	760	220	190	23	105	24	145	1116
							315M	1840	800	820	760	220	190	23	80	24	120	1212

本型錄產品規格因產品改良而有所變更時恕不另行通知，訂購時請先確認。

Note: Because we are constantly working to improve performance and upgrade our products, specifications and diagrammatic representations in this catalog may change without notice.

## 客製化開發專案 Customized Development Services

本公司具有豐富客製化產品經驗，可針對客戶專用產品提供客製化專案開發服務。如您需要的產品規格不在型錄中或是有特別使用條件（例如特高壓力、特高黏度，或是更大或更小流量需求），請向本公司業務部門或是技術部門洽詢相關細節。

We are well experienced in customized products. Customized Development Services can be provided for exclusive products owned by the customer. In case your application is not covered by the products listed in our catalog or is subject to special operation requirements (such as ultra high pressure, ultra high viscosity, or for very large or very small flow rates), please consult our Sales Department or Technical Department for further assistance.

## 其他產品 Other Products



液封式真空泵浦  
Liquid Ring Vacuum Pump



衛生泵浦  
Sanitary Rotary Lobe Pump



雙軸螺旋泵浦  
Twin Screw Pump



機械助力真空泵  
Mechanical Booster Vacuum Pump



高溫熱媒泵浦  
High Temperature Pump

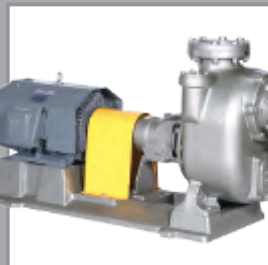

製程級自吸泵  
Self-priming Process Pump



三軸螺旋泵浦  
Three Screw Pump

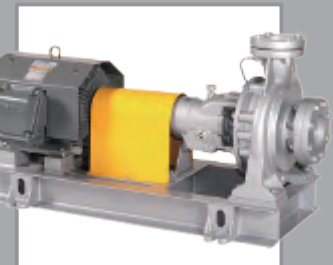

離心式製程泵浦  
Centrifugal Process Pump



**三錦機器股份有限公司**  
**SUNNY KING MACHINERY CO., LTD**

| 官方網址 | Official Website : [www.sunny-king.com.tw](http://www.sunny-king.com.tw)  
| 聯絡我們 | Contact Us : [skpump@sunny-king.com.tw](mailto:skpump@sunny-king.com.tw)

■ 台北公司 **Taipei Office** 104台北市中山區民生東路二段147巷5弄12號  
No.12, Alley 5, Lane 147, Sec. 2, Minsheng E. Rd., Zhongshan District, Taipei City 104, Taiwan  
Tel:+886-2-2509-0049 Fax:+886-2-2509-4194

■ 新莊廠 **Xinzhunag Factory** 242新北市新莊區新樹路234巷1號  
No.1 Lane 234 Xinshu Rd. Xinzhuang District, New Taipei City 242, Taiwan  
Tel:+886-2-2202-0224~6 Fax:+886-2-2202-7354

■ 中壢廠 **Zhongli Factory** 320桃園市中壢區南園路16號(中壢工業區)  
No.16, Nanyuan Rd., Zhongli District, Taoyuan City 320, Taiwan  
Tel:+886-3-451-1969 Fax:+886-3-452-8602

地區經銷：

■ 台中 昌錦企業  
407台中市西屯區工業42路33號  
Tel:+886-4-2359-4673 Fax:+886-4-2359-4723  
E-mail:ccpump@ms57.hinet.net

■ 高雄 東震行  
807高雄市三民區中華二路199號  
Tel:+886-7-321-1745~6 Fax:+886-7-321-1747  
E-mail:t3211745@ms41.hinet.net

■ 昆山正錦精密機械有限公司  
215312江蘇省昆山市巴城鎮石牌京阪路1288號  
Tel:0512-5782-3681~3 Fax:0512-5519-0466  
E-mail:w-c@sunny-king.com.tw