

E 型聯軸器 E-TYPE COUPLING

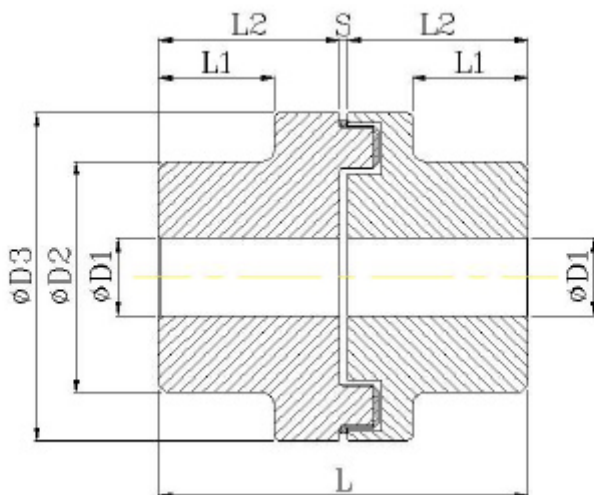

技術資料 Technical Data

Model	Torque (Normal) Kg . m	Torque (Max.) Kg . m	Max. R.P.M	D1 Shaft Max.Dia. (mm)	D2 mm	L mm	D3 mm	L1 mm	L2 mm	S mm	GD ² (11) Kg.m ²	Weight	
												(11) Kg.m ²	Kg
E-82	5.0	9	8,000	28	53	83	82	24	40	3.5±1.5	0.0023	0.87	1.76
E-112	16.7	30	6,000	42	79	123.5	112	38	60	4±1.5	0.0105	2.45	5.0
E-128	26.7	48	5,000	48	90	143.5	128	45	70	4±1.5	0.0225	3.9	7.9
E-148	41.7	75	4,500	55	107	163.5	148	52	80	4.5±2	0.0380	6.1	12.3
E-168	69.5	125	4,000	75	124	183.5	168	56	90	4.5±2	0.0920	9.1	18.4
E-194	112	200	3,500	85	140	203.5	194	62	100	4.5±2	0.1788	13	26.3

本公司有保留變更資料之權利，訂購時請先確認。

Any changes in the interests of the technical development are reserved. Please confirm the specification before purchase.